

Madison, Wisconsin

CITY OF MADISON

CITY ENGINEERING DIVISION
DEPARTMENT OF PUBLIC WORKS

PLAN OF PROPOSED IMPROVEMENT

BLOCK 11 BOWENS ADDITION ALLEY
ASSESSMENT DISTRICT - 2014

CITY PROJECT NO. 53WI583

CONTRACT NO. 7228

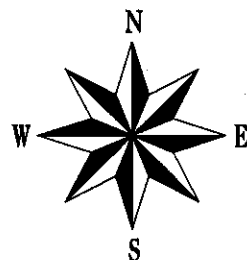

CONSTRUCTION
PROJECT LOCATIONS

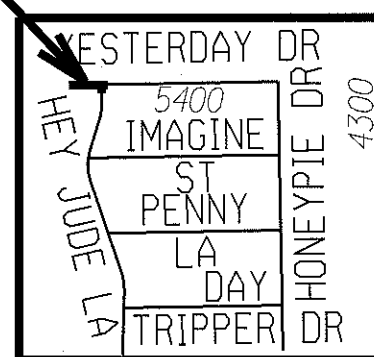
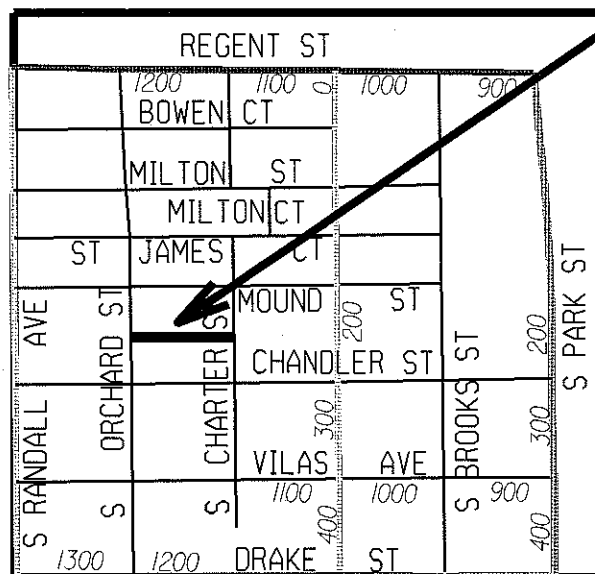

INDEX OF SHEETS

SHEET NO.	TITLE
1	DETAILS - TYPICAL SECTION
DI	PLAN & PROFILE - ALLEY & YESTERDAY DR
PI-P2	UTILITY PLAN & PROFILE - ALLEY
U1	STORM SEWER SCHEDULES
U2	CROSS-SECTIONS ALLEY
XI-X2	

CONVENTIONAL SIGNS

FIELD VERIFY ALL UTILITY LOCATIONS

GAS	— G —
STORM SEWER	— ST —
SANITARY SEWER	— SAN —
WATER	— W —
OVERHEAD ELECTRIC	— OH —
POWER POLE	□
ADA COMPLIANT RAMP W/ DETECTABLE WARNING FIELD	□
COMBUSTIBLE FLUIDS	☀

NOTES:

ALL GUTTERS SHALL DRAIN WITH A MINIMUM GRADE OF 0.50% TOWARD STORM SEWER INLETS.

EARTH WORK SUMMARY:

TOTAL EXCAVATION CUT(MEASURED PLAN QUANTITY) 370 C.Y.
 (ALLEY..... 300 C.Y.)
 (YESTERDAY DRIVE..... 70 C.Y.)
 ESTIMATED UNDISTRIBUTED UNDERCUT 45 C.Y.
 TOTAL UNCLASSIFIED EXCAVATION CUT 415 C.Y.

PUBLIC IMPROVEMENT PROJECT APPROVED

June 3, 2014

BY THE COMMON COUNCIL OF MADISON, WISCONSIN

PUBLIC IMPROVEMENT DESIGN APPROVED BY:

[Signature] 6/6/14
City Engineer Date

STREET DESIGNED BY:

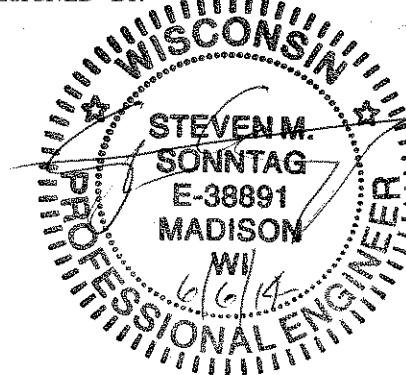

STORM SEWERS DESIGNED BY:

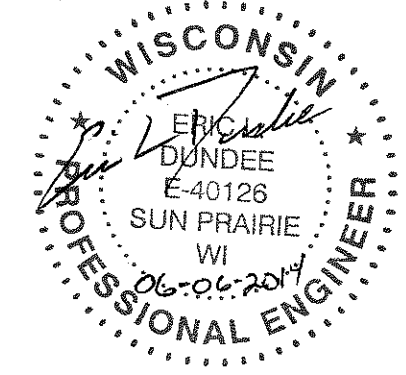

PLOT SCALE: _____
REV. DATE: _____
ORIGINATOR: CITY OF MADISON, STREETS DIVISION

- ① POINT REFERRED TO ON PROFILE
 - ② 1¼" BITUMINOUS UPPER LAYER, TYPE E-0.3
 - ③ 1¼" BITUMINOUS LOWER LAYER, TYPE E-0.3
 - ④ 10" GRADATION 2 CRUSHED AGGREGATE
 - ⑤ FILL, INCIDENTAL WHERE CURB IS REPLACED
 - ⑥ ALLEY CURB
- * SEE CROSS SECTION SHEETS FOR CROSS SLOPES AND TOP OF CURB ELEVATIONS.
TYPICAL SECTION NOT TO SCALE

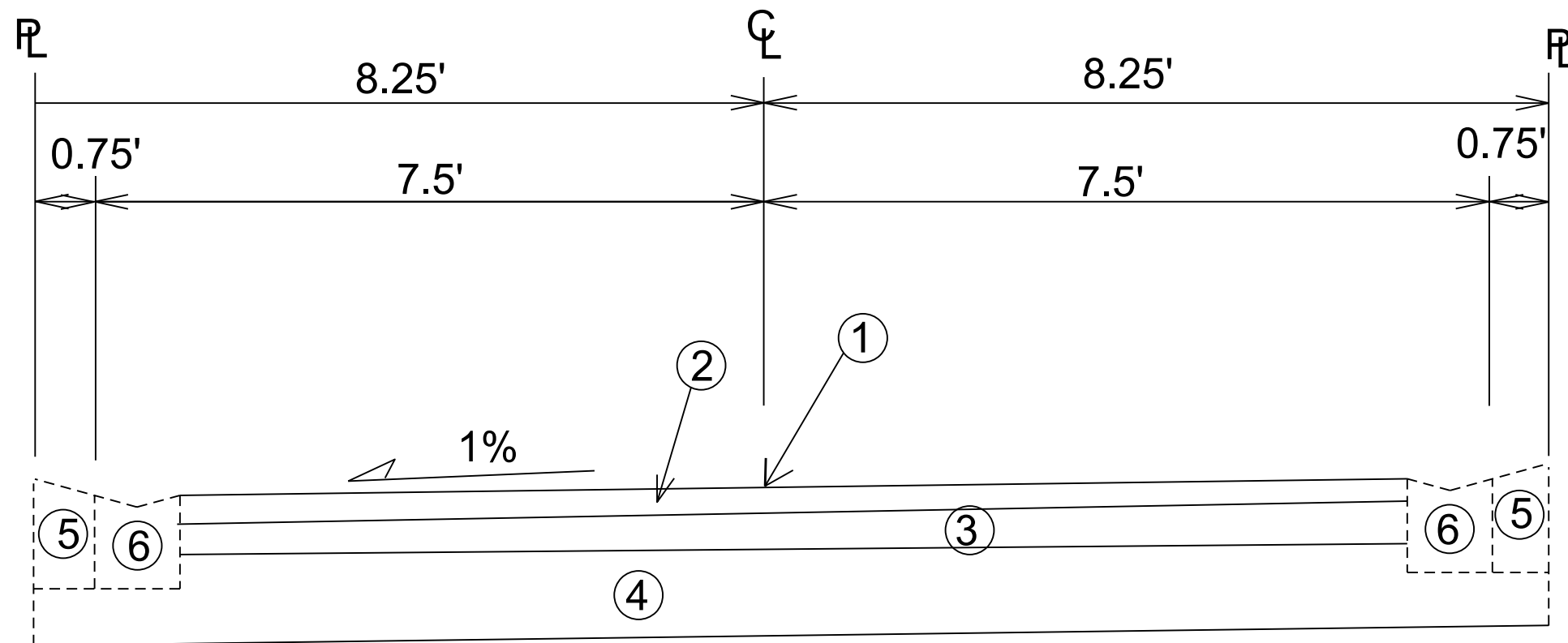

TYPICAL FINISHED SECTION

ALLEY

PLOT SCALE: _____

PLOT NAME: _____

REV. DATE: _____

ORIGINATOR: CITY OF MADISON, STREETS DIVISION

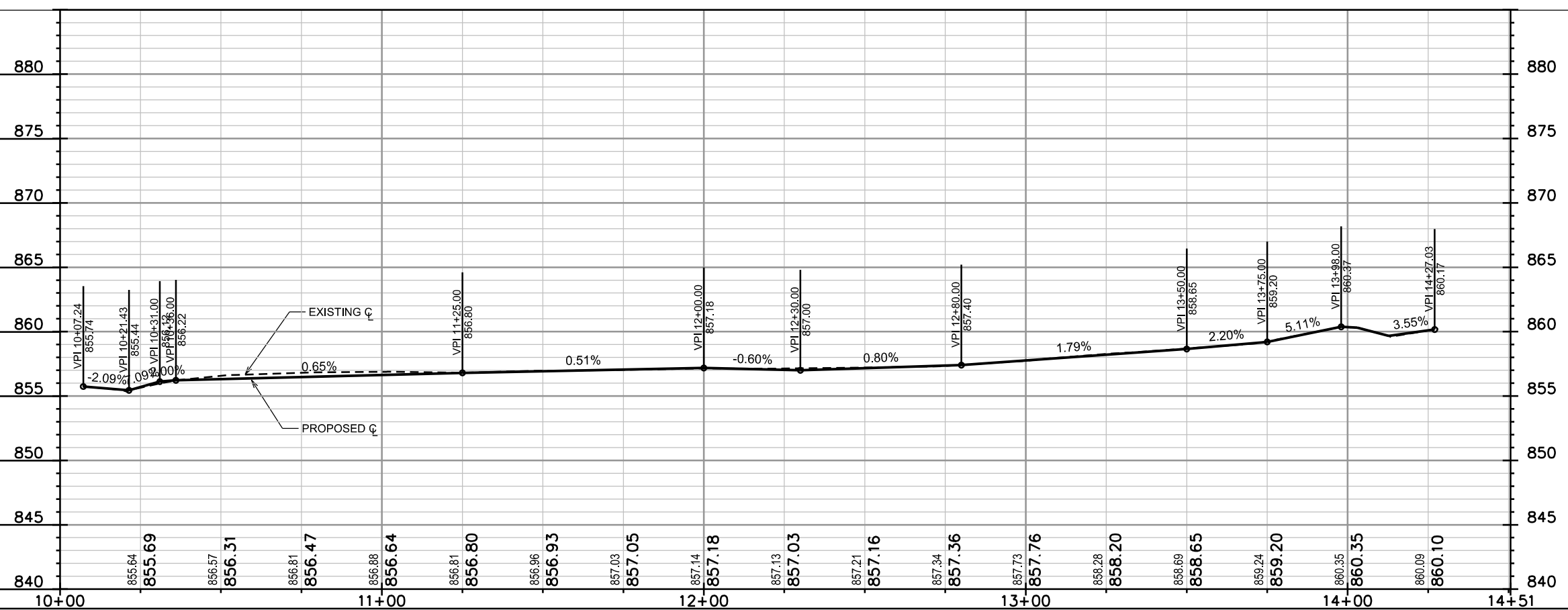
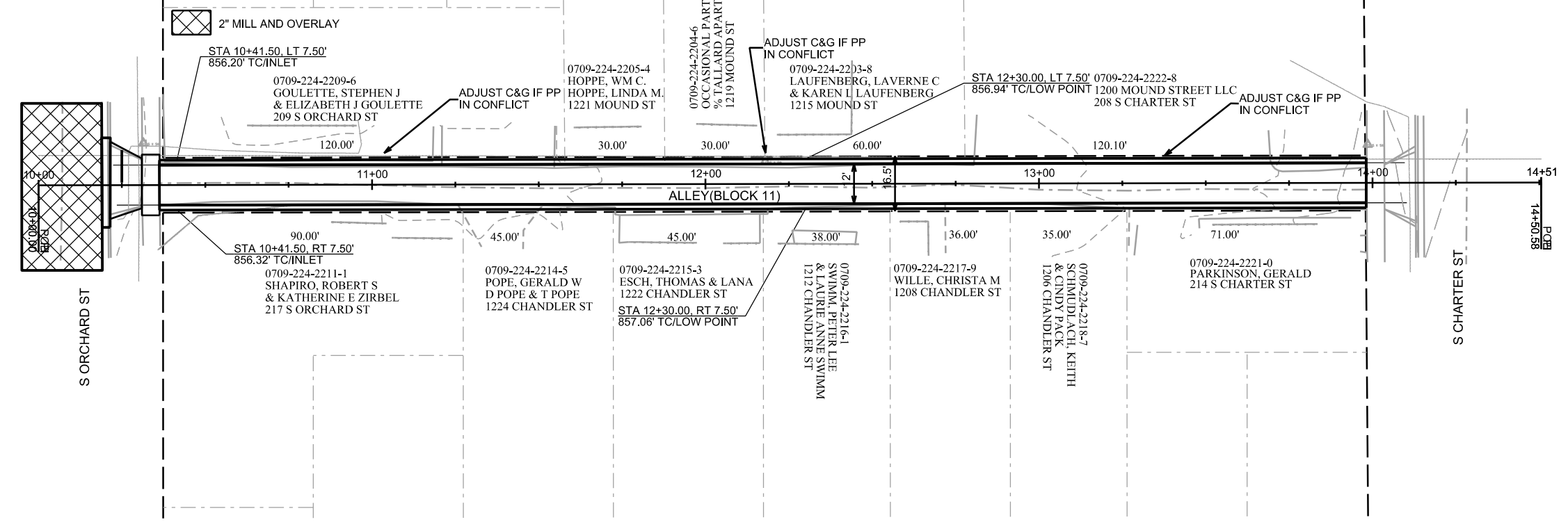

PLOT SCALE: _____
 PLOT NAME: _____
 REV. DATE: _____
 ORIGINATOR: CITY OF MADISON, STREETS DIVISION

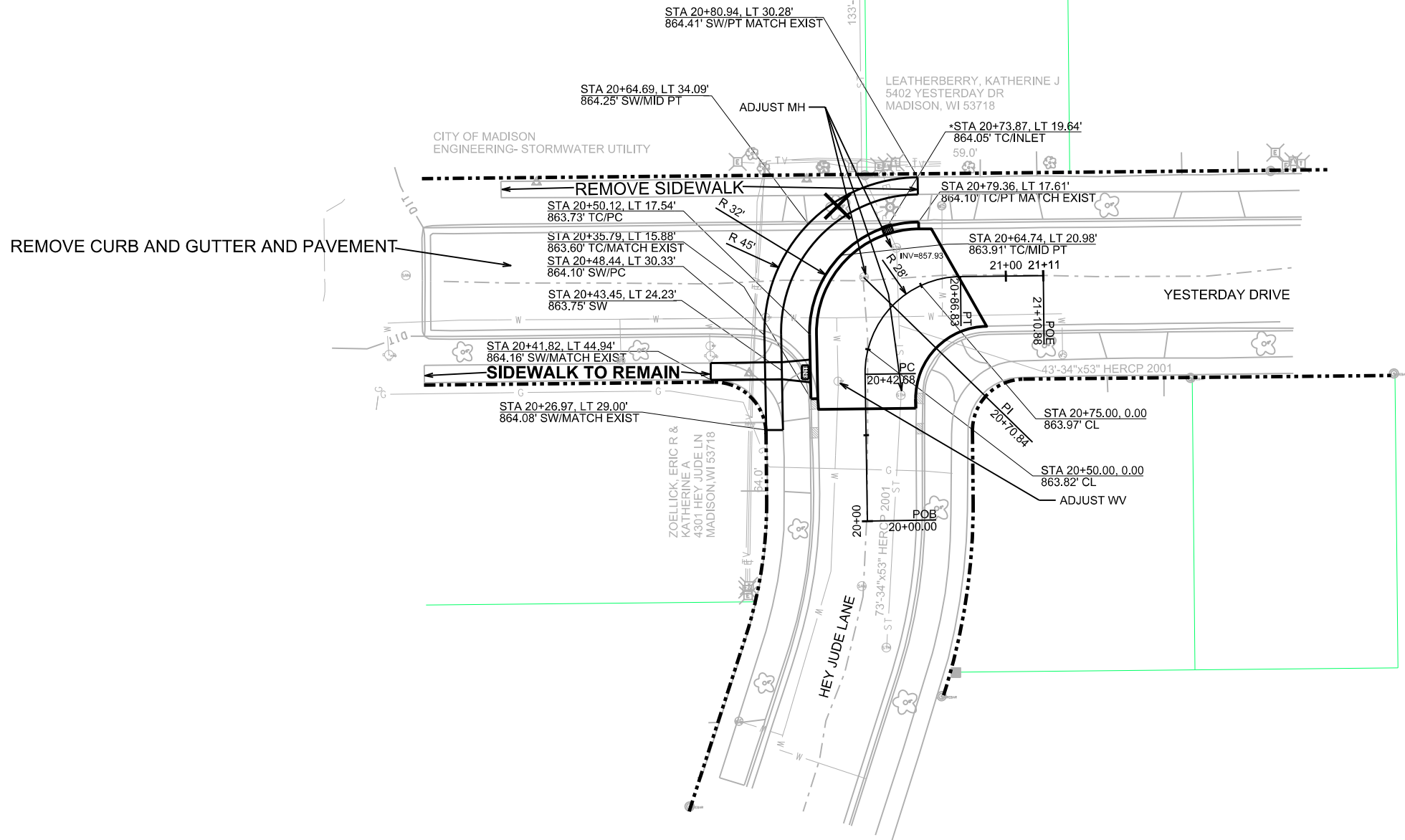
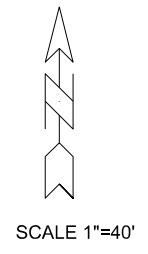

* NOTE:
STA 20+73.87, LT 19.64' IS A SADDLED H- INLET TYPE II
PER S.D.D. 5.7.9 WITH AN R-3067-7004-V CASTING

ORIGINATOR: CITY OF MADISON, STREETS DIVISION
PLOT SCALE: _____
PLOT NAME: _____
REV. DATE: _____

REV 09/04/2014 ELD

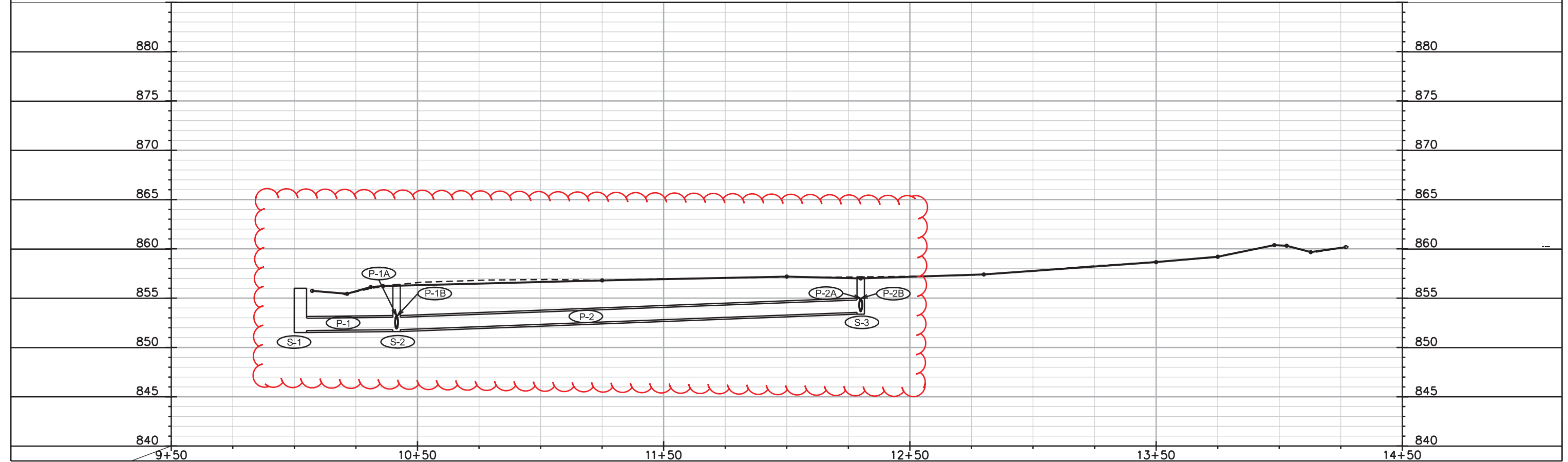
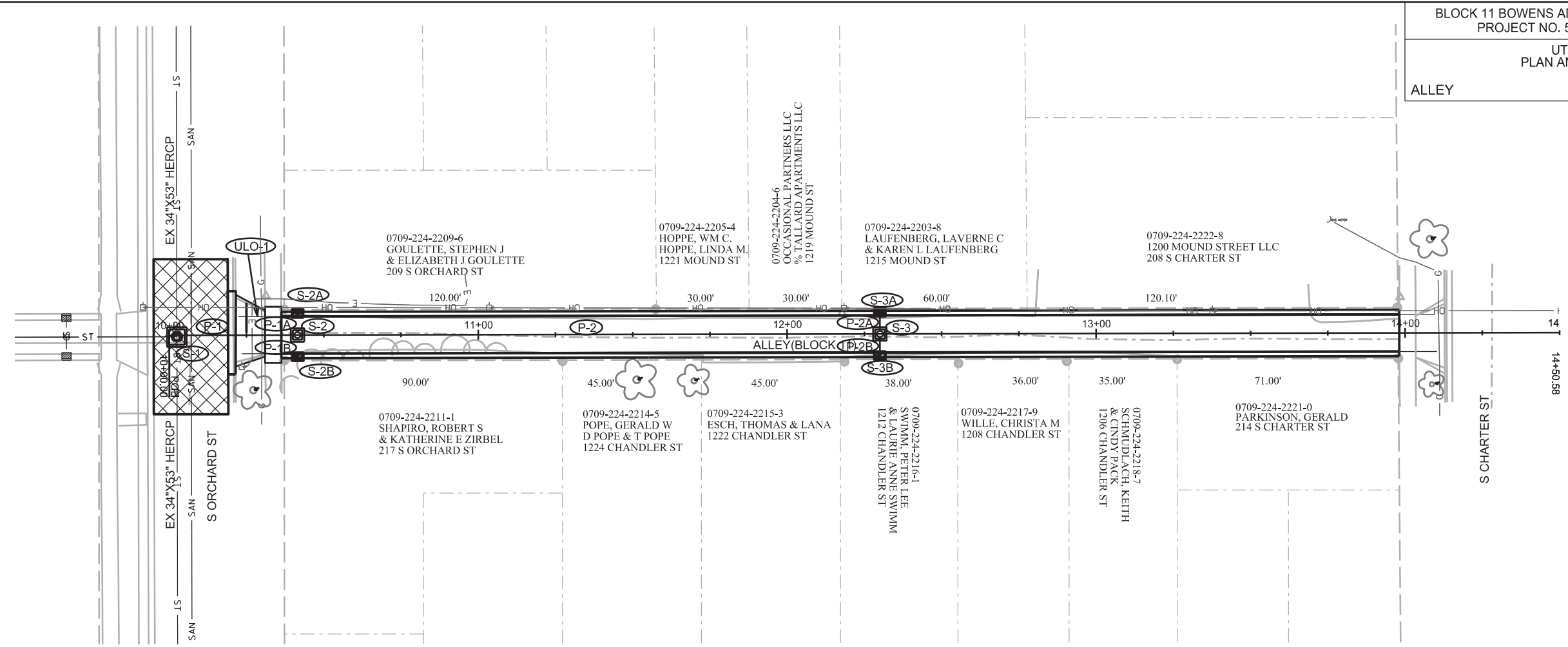

PLOT SCALE: _____

PLOT NAME: _____

REV. DATE: _____

ORIGINATOR: CITY OF MADISON, STREETS DIVISION

STORM SEWER SCHEDULE

REVISED 09/04/2014 ELD

BLOCK 11 BOWENS ADDITION ALLEY

SHEET NO.

PROJECT NO. 53W1583

U-2

ALLEY
STORM SEWER SCHEDULE

CITY OF MADISON

STRUCTURES

STRUC. NO.	STATION	LOCATION (OFFSET)	TYPE	TOP OF CASTING	E.I.	DEPTH	NOTES
S-1	10+02.51	CL	5X5 SAS	856.00	851.68	4.32	FP; W/ R-1550-0054
S-2	10+41.51	CL	3X3 SAS	856.36	851.80	4.56	W/ R-1550-0054
S-2A	10+41.51	LT-6.75	H INLET	856.20	852.90	3.30	W/ R-3362-L; PER SDD 5.7.33
S-2B	10+41.50	RT-6.75	H INLET	856.32	852.90	3.42	W/ R-3362-L; PER SDD 5.7.33
S-3	12+30.00	CL	3X3 SAS	857.15	853.56	3.59	W/ R-1550-0054
S-3A	12+30.00	LT-6.75	H INLET	856.94	853.85	3.09	LP; W/ R-3362-L; PER SDD 5.7.33
S-3B	12+30.00	RT-6.75	H INLET	857.06	853.85	3.21	LP; W/ R-3362-L; PER SDD 5.7.33

PIPES

PIPE NO.	FROM (DNSTM)	TO (UPSTM)	PLAN LENGTH (FT)	PIPE LENGTH (FT)	DISCH. E.I.	INLET E.I.	SLOPE (%)	PIPE SIZE	TYPE	NOTES
* P-1	S-1	S-2	39	36	851.68	851.80	0.27%	15"	RCP	-
* P-1A	S-2	S-2A	7	4	852.05	852.90	18.88%	12"	RCP	-
* P-1B	S-2	S-2B	7	4	852.05	852.90	18.82%	12"	RCP	-
* P-2	S-2	S-3	189	185	851.80	853.56	0.95%	15"	RCP	-
P-2A	S-3	S-3A	7	4	853.81	853.85	0.89%	12"	RCP	-
P-2B	S-3	S-3B	7	4	853.81	853.85	0.89%	12"	RCP	-

NOTE: PLAN LENGTH IS FROM CENTER OF STRUCTURE TO CENTER OF STRUCTURE.
 PIPE LENGTH IS ACTUAL LENGTH OF PIPE FROM STRUCTURE WALL TO STRUCTURE WALL.
 SLOPE CALCULATED USING PIPE LENGTH.

ULO SCHEDULE

ID NO.	STATION	LOCATION (OFFSET)	TYPE	NOTES
ULO-1	10+29.00	CL	GAS (3" PL) TOP=852.60 ELEC(2" PVC) TOP=853.70	RELOCATION NEEDED CLEAR

STANDARD NOTES:

- ABBREVIATIONS: AE = APRON ENDWALL; RCP = REINFORCED CONCRETE PIPE; HERCP = HORIZONTAL ELLIPTICAL REINFORCED CONCRETE PIPE; DNA = DOES NOT APPLY; SAS = SEWER ACCESS STRUCTURE; LP = LOW POINT INLET STRUCTURE; FP = FIELD Poured STRUCTURE; TR = TOP OF CONCRETE ROOF; NCM = NO CROWN MATCH FOR PIPES
- APPROXIMATE DISCHARGE E.I. GIVEN, ADJUST E.I. AND PIPE SLOPE IN THE FIELD.
- TOP OF CASTING GRADE GIVEN IS THE TOP OF CURB FOR INLET STRUCTURES AND THE FLOWLINE OF THE CLOSED CASTING FOR SAS's.
- TOP OF CONCRETE ROOF (TR) IS 1.25' BELOW TOP OF CASTING UNLESS OTHERWISE NOTED.
- ALL REINFORCED CONCRETE PIPES TO BE CLASS III UNLESS OTHERWISE NOTED.
- SURVEYOR TO CONFIRM THAT ALL INLET STATION / OFFSETS LINE UP WITH PROPOSED CURB AND GUTTER.
- ALL STRUCTURES CALLED OUT AS FIELD Poured SHALL BE FIELD Poured. ALL OTHER STRUCTURES (NOT INDICATED AS FIELD Poured) SHALL BE SUBMITTED TO CITY ENGINEERING FOR APPROVAL IF PRECAST STRUCTURES ARE PREFERRED. CONTACT ELIA E. ACOSTA OF CITY ENGINEERING AT (608) 266-4096 FOR PRECAST APPROVALS, OR FAX SHOP DRAWINGS TO (608)264-9275.

CROSS SECTIONS

ALLEY CITY OF MADISON

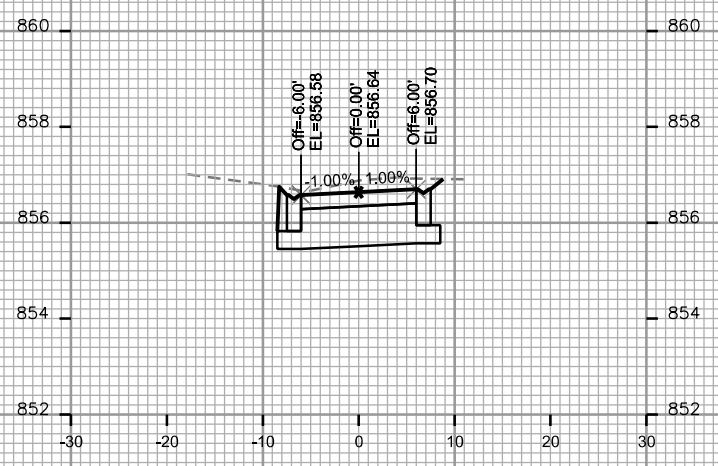

STA. 11+00

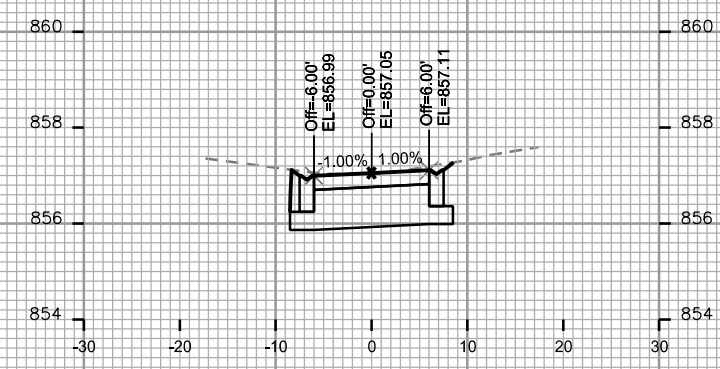

STA. 11+75

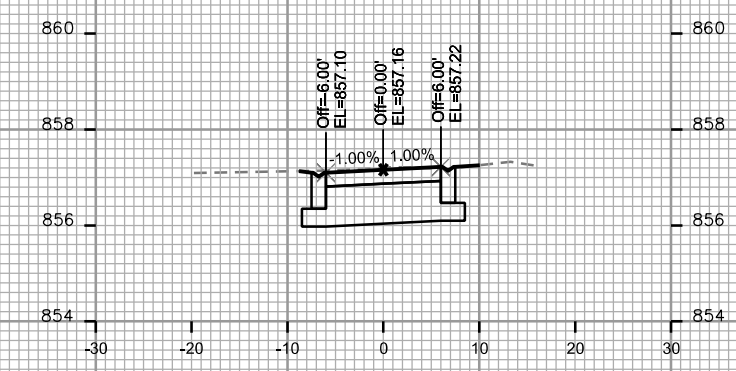

STA. 12+50

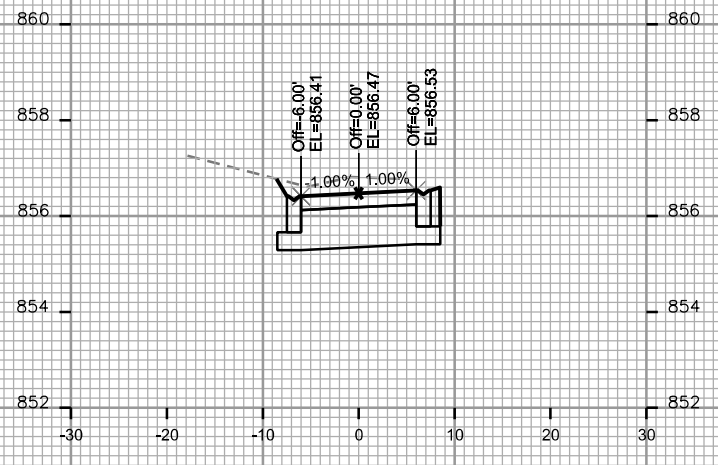

STA. 10+75

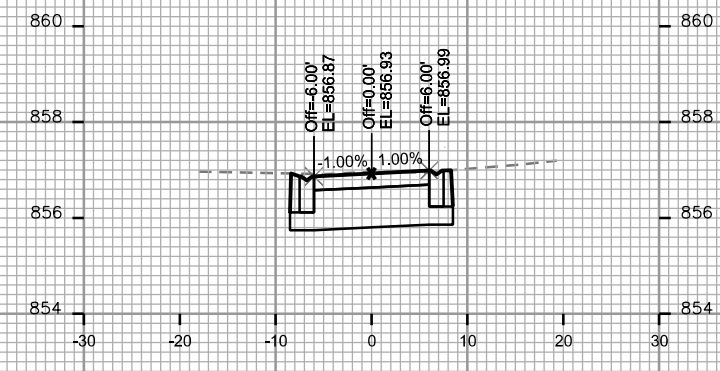

STA. 11+50

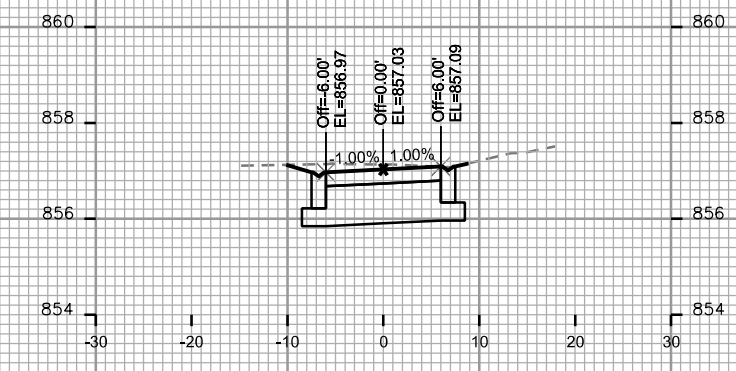

STA. 12+25

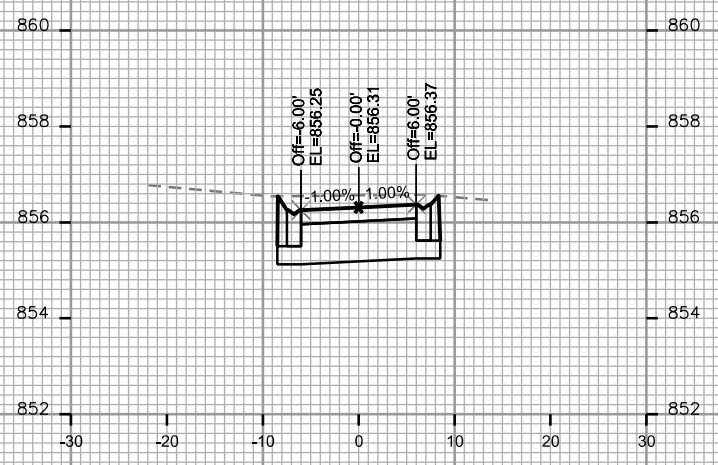

STA. 10+50

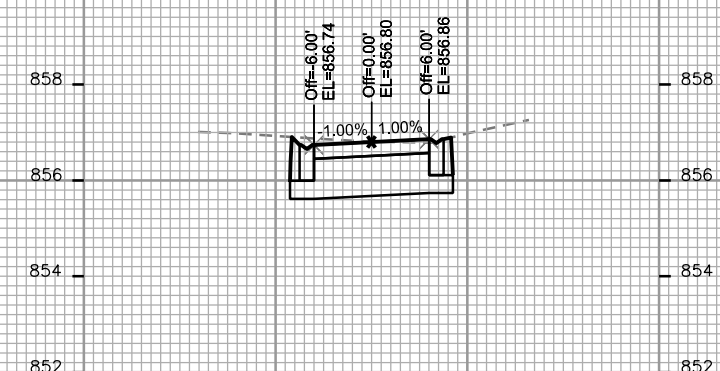

STA. 11+25

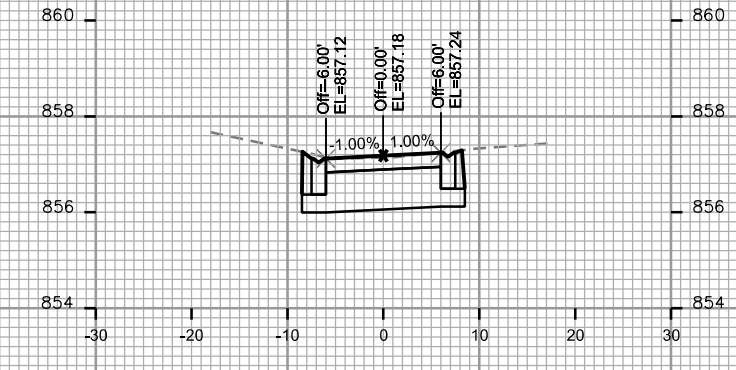

STA. 12+00

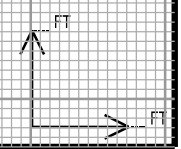

PLOT SCALE: _____

PLOT NAME: _____

REV. DATE: _____

ORIGINATOR: CITY OF MADISON - STREETS DIVISION

PLOT SCALE: _____

PLOT NAME: _____

REV. DATE: _____

ORIGINATOR: CITY OF MADISON - STREETS DIVISION

